

PRE-ASSEMBLED STAINLESS STEEL MANIFOLD

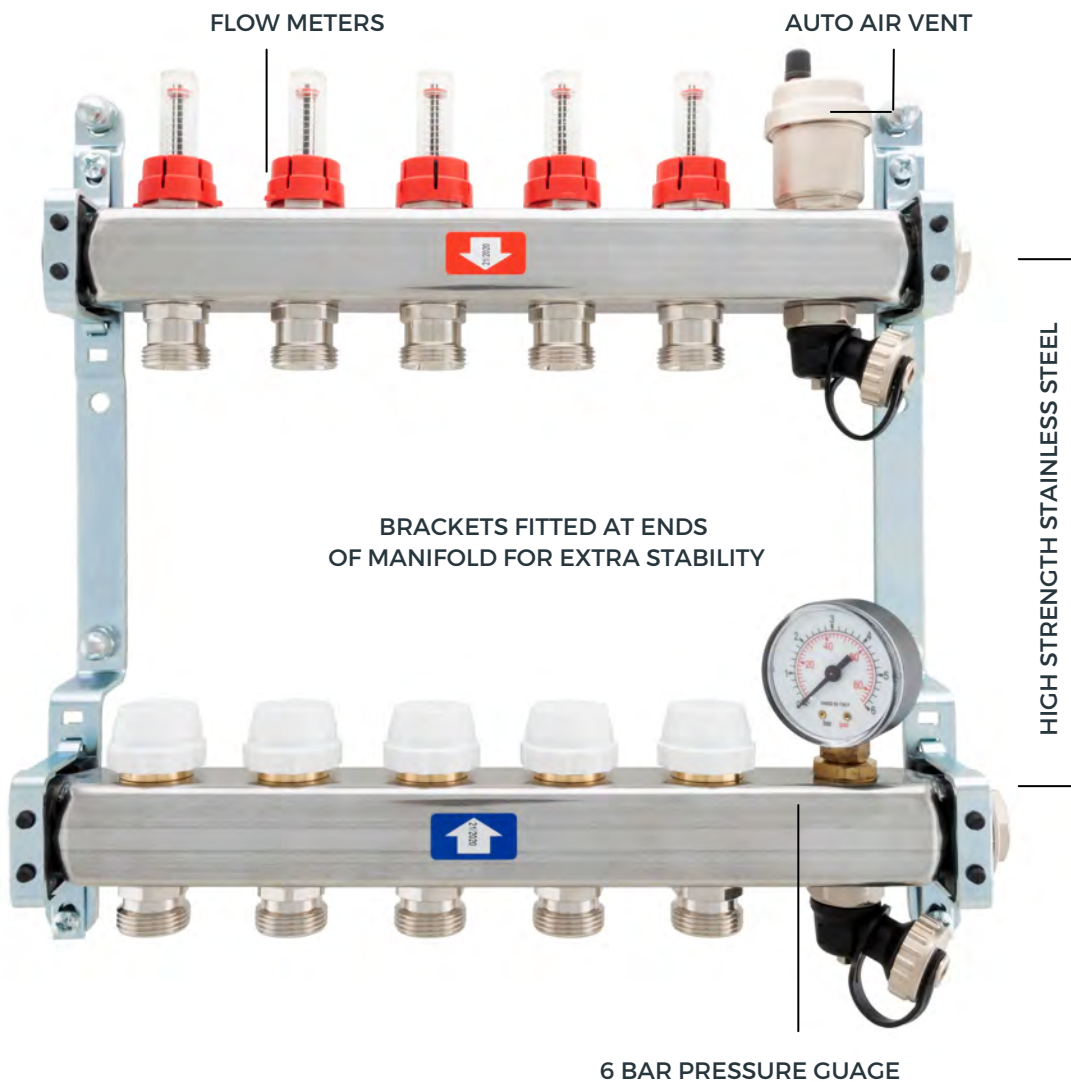

100% TESTED PRIOR TO PACKAGING



0161 711 0612



sales@rhs ltd.co.uk

PRE-ASSEMBLED STAINLESS STEEL MANIFOLDS

PACK CONTAINS:

1 x Preassembled Stainless Steel Manifold

2 x Complete metal mounting brackets

2 x Fill and Drain cocks

1 x Air vent

1 x Pressure gauge

TECHNICAL CONDITIONS

Required Fluid	Water maximum glycol 30%
Maximum operating pressure with installed flow meters	6 bar
Maximum operating temperature with installed flow meters	70 OC
Main ISO Connections	1"
2 to 12 outlets	3/4 Eurokonus
Outlet centre-distance	50mm
Flow Meters	Taconova
Pressure Guage	6 bar
Auto Air Vent	10 bar

OPTIONAL EXTRAS (NOT IN STANDARD KIT)

Manifold pump and mixing kit as specified

2 x 1" ball valves to suit pump and mixing set

Eurokonus fittings to suit system requirements

Electrothermic Actuators



0161 711 0612



sales@rhsltd.co.uk

DIMENSIONS MANIFOLD ARMS ONLY

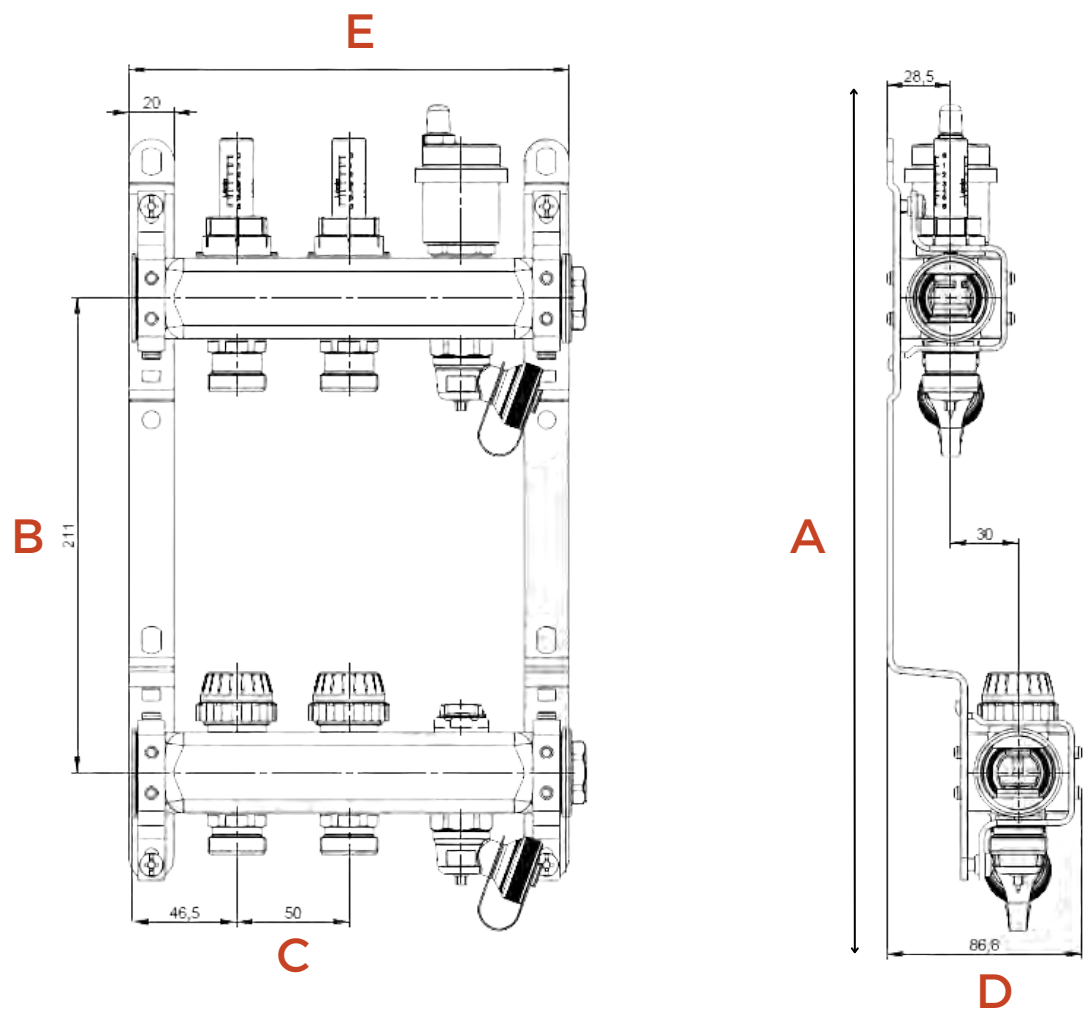

CODE	PRODUCT	CONNECTIONS	OVERALL HEIGHT	PRIMARY CENTRES	PORT CENTRES	FITTED DEPTH (no pump)	OVERALL WIDTH (No pump or ball valves)	ADD BALL VALVE (If fitted on bars)	STANDARD PUMP WIDTH (check actual specification)	OVERALL WIDTH (With standard pump & ball valves)	FITTED DEPTH (with standard pump)
		SIZE	A	B	C	D	E				
RHS00-002	2 CIRCUIT UFH MANIFOLD KIT	1"	335	211	50	88	202	80	110	392	175
RHS00-003	3 CIRCUIT UFH MANIFOLD KIT	1"	335	211	50	88	252	80	110	442	175
RHS00-004	4 CIRCUIT UFH MANIFOLD KIT	1"	335	211	50	88	302	80	110	492	175
RHS00-005	5 CIRCUIT UFH MANIFOLD KIT	1"	335	211	50	88	352	80	110	542	175
RHS00-006	6 CIRCUIT UFH MANIFOLD KIT	1"	335	211	50	88	402	80	110	592	175
RHS00-007	7 CIRCUIT UFH MANIFOLD KIT	1"	335	211	50	88	452	80	110	642	175
RHS00-008	8 CIRCUIT UFH MANIFOLD KIT	1"	335	211	50	88	502	80	110	692	175
RHS00-009	9 CIRCUIT UFH MANIFOLD KIT	1"	335	211	50	88	552	80	110	742	175
RHS00-010	10 CIRCUIT UFH MANIFOLD KIT	1"	335	211	50	88	602	80	110	792	175
RHS00-011	11 CIRCUIT UFH MANIFOLD KIT	1"	335	211	50	88	652	80	110	842	175
RHS00-012	12 CIRCUIT UFH MANIFOLD KIT	1"	335	211	50	88	702	80	110	892	175

All dimensions in mm unless otherwise stated



0161 711 0612



sales@rhsLtd.co.uk

FLOW RATE ADJUSTMENT

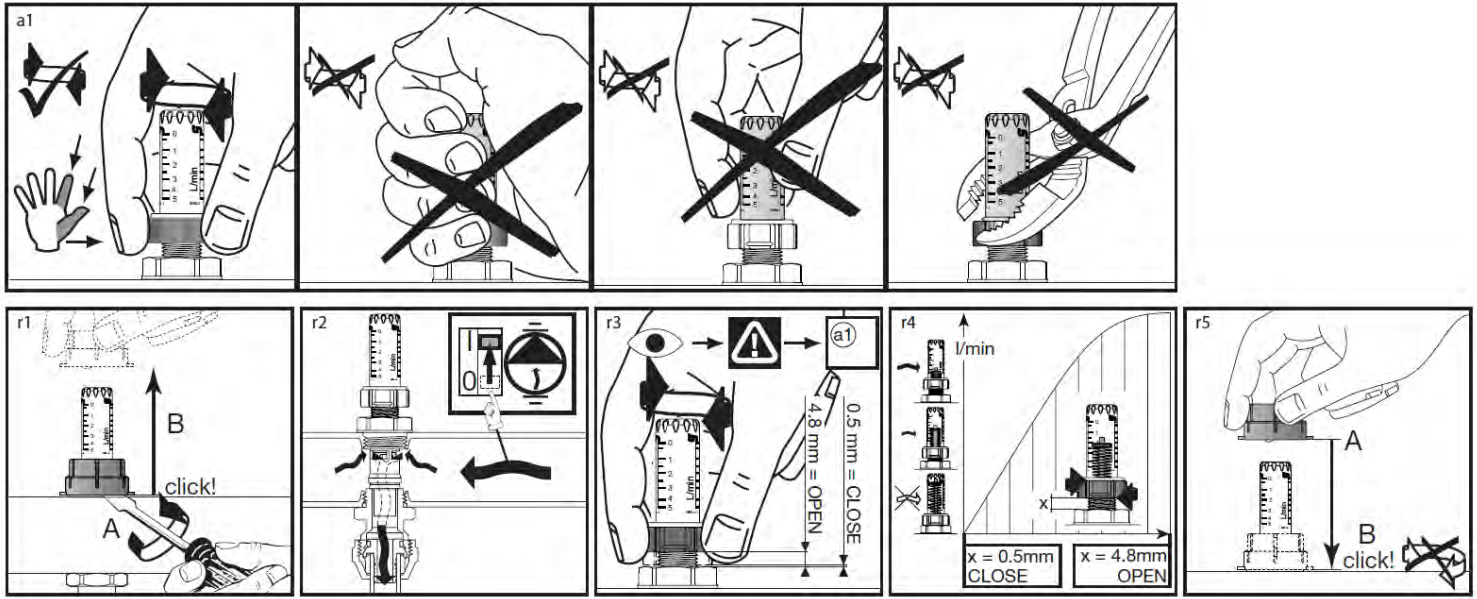

The pre-setting valve works as a regular valve (ON-OFF operation), if it is used in its totally open position.

In case of installation of manifolds equipped with pre-setting valves, the flowmeter is not to be used as a balancing valve, but only to read to required flow rate.

FLOW RATE ADJUSTMENT AND ACTUATOR INSTALLATION

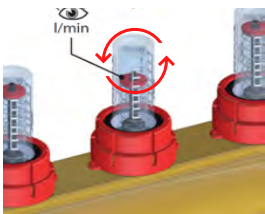

Adjust the flow rate of each circuit by turning the insert anti-clockwise until you read the required flow rate.

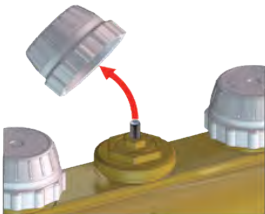

Remove the plastic cap from the valve, installed on return manifold.



Remove the plastic cap installed on the return manifold and install actuator head if required.

FLOW METER PRESSURE

Flow meter pressure drop with electrothermic body fully open.

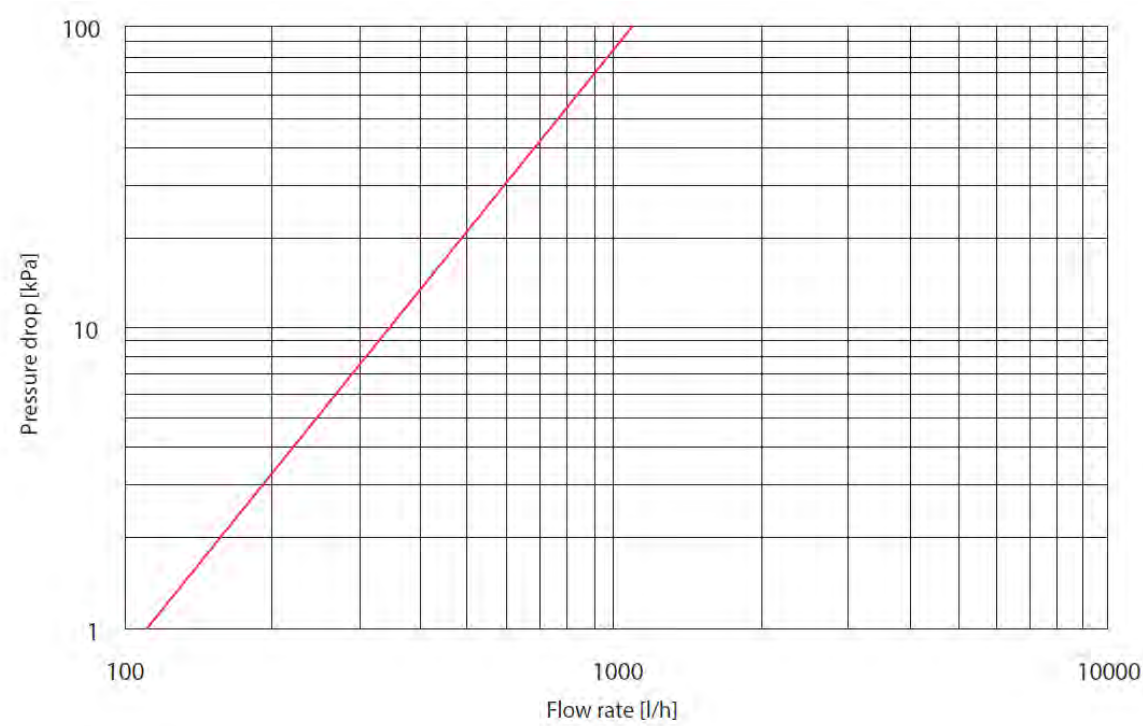

Kv - 1.1 m³/h

Regulation lockshield diagram (flow manifold)

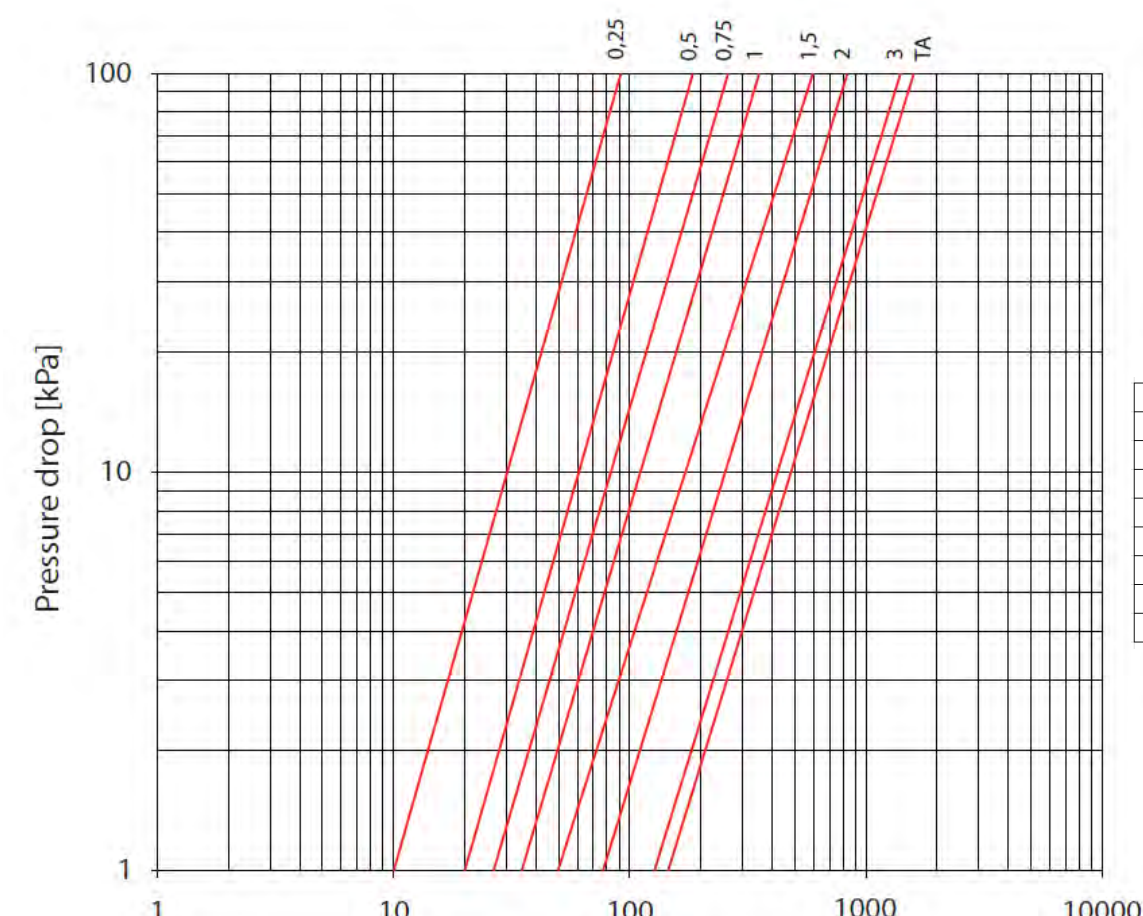

Regulation rpm	Kv m³/h
0.25	0.09
0.5	0.19
0.75	0.27
1	0.36
1.5	0.6
2	0.83
3	1.45
TA (open)	1.65